







**Come and experience the magic of Courchevel...**

Always a warm welcome at the magnificent Chalets – Le 1946 – and – Le 1992 – your residence for a unique stay in Courchevel Le Praz.

Drawing upon my family's heritage and the expertise gained during 10 years working in luxury hotels, my knowledge and experience is at your service for an exceptional holiday in the mountains. Offering our guests a truly personalised service worthy of the palaces in which I gained our experience remains my top priority throughout your stay.

Take the opportunity to plunge into the magic of the largest ski area in the world and discover the warm and welcoming atmosphere of our beautiful chalets.

Sylvain René-Fischl



**Chalet Le 1992**

**210**  
m2

**8 / 10**  
Adults

**4**  
Bedrooms

**150**  
Meters from  
the slopes

**1**  
Outdoor wellness  
area & Ski room





## A little history

### THE OLYMPIC GAMES

When we built the chalet – Le 1992 – back in 2012, ten years after the construction of our other chalet, we wanted to reflect the excitement of the Albertville Winter Olympics Games in 1992.

This event was particularly important for the resort of Courchevel and the village of Le Praz, where the ski jumping events took place.

An astounding and impressive discipline with flights of up to 140 metres, standing in front of the ‘Tremplins du Praz’ you will be in awe when you see the ski jumpers’ training sessions.

Our family history is tied to this sport, Sylvain having practiced it for several years under the watchful yet supportive eye of his grandmother, Mamie Angèle. Ideally situated near the village facilities and the new cable car which gives access to Courchevel 1850 in just eight minutes, this modern and authentic mountain chalet will charm you with its style and comfort.

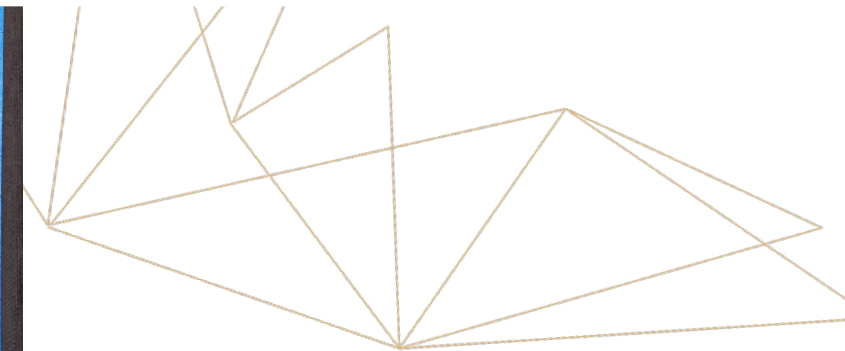





## Kitchen & Dining Room

SHARE COSY MOMENTS WITH FAMILY OR FRIENDS

The open kitchen combines charm and functionality, with the exceptional quality of the Zimbabwean granite worktop making a magnificent bar upon which to share a delicious coffee from the Jura bean machine, or sip one of the excellent wines or champagnes from your cellar.

The dining room and its large 12-person table makes a perfect spot to gather with your family and friends to share a convivial meal whilst logs crackle gently in the stunning fireplace which is a centrepiece for the room.



## Living room

A ROOM WITH A VIEW

Take a seat in this gorgeous living room, share stories and relax after a fantastic day on the slopes. With a modern sofa, a central fireplace, designer lighting, and the beauty of natural materials, this chalet blends contemporary style with Savoyard authenticity.

Located on the uppermost floor, the balcony is a perfect spot for soaking up the rays or admiring the snow-capped mountains.





# Master bedroom

SPACIOUS & LUMINOUS

This magnificent, south-facing master bedroom with balcony has a queen size bed which could also be separated as twins, a small desk, and a sofa. Spacious and perfectly furnished, there is also space to add a cot if required.

You will fall in love with the beautifully bright bathroom with double basins and large bathtub; an ideal spot to unwind.

20m<sup>2</sup> bedroom  
King bed 180cm x 200cm or two singles

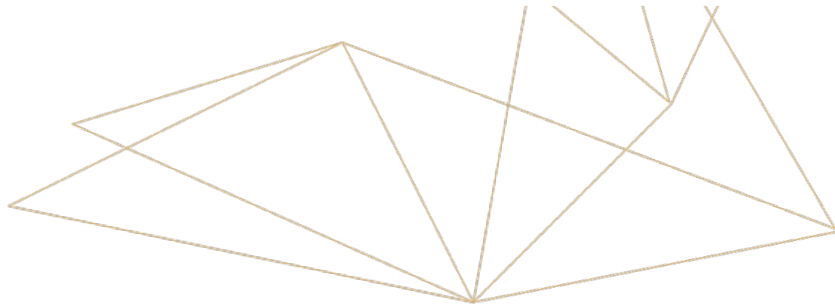



# L'Eclipse

A NOD TO THE 2023 WORLD CHAMPIONSHIPS

Named after the legendary downhill slope down which champions fly into Le Praz, this large bedroom will delight you with its warm tones. Equipped with a King size bed which can also be made into twins, this spacious room also has the option of adding a sofa bed or a cot. The comfortable and functional bathroom is equipped with a walk-in shower and double basin.

18m<sup>2</sup> bedroom  
Queen size bed 160cm x 200cm  
Sofa bed 140cm x 200cm or cot

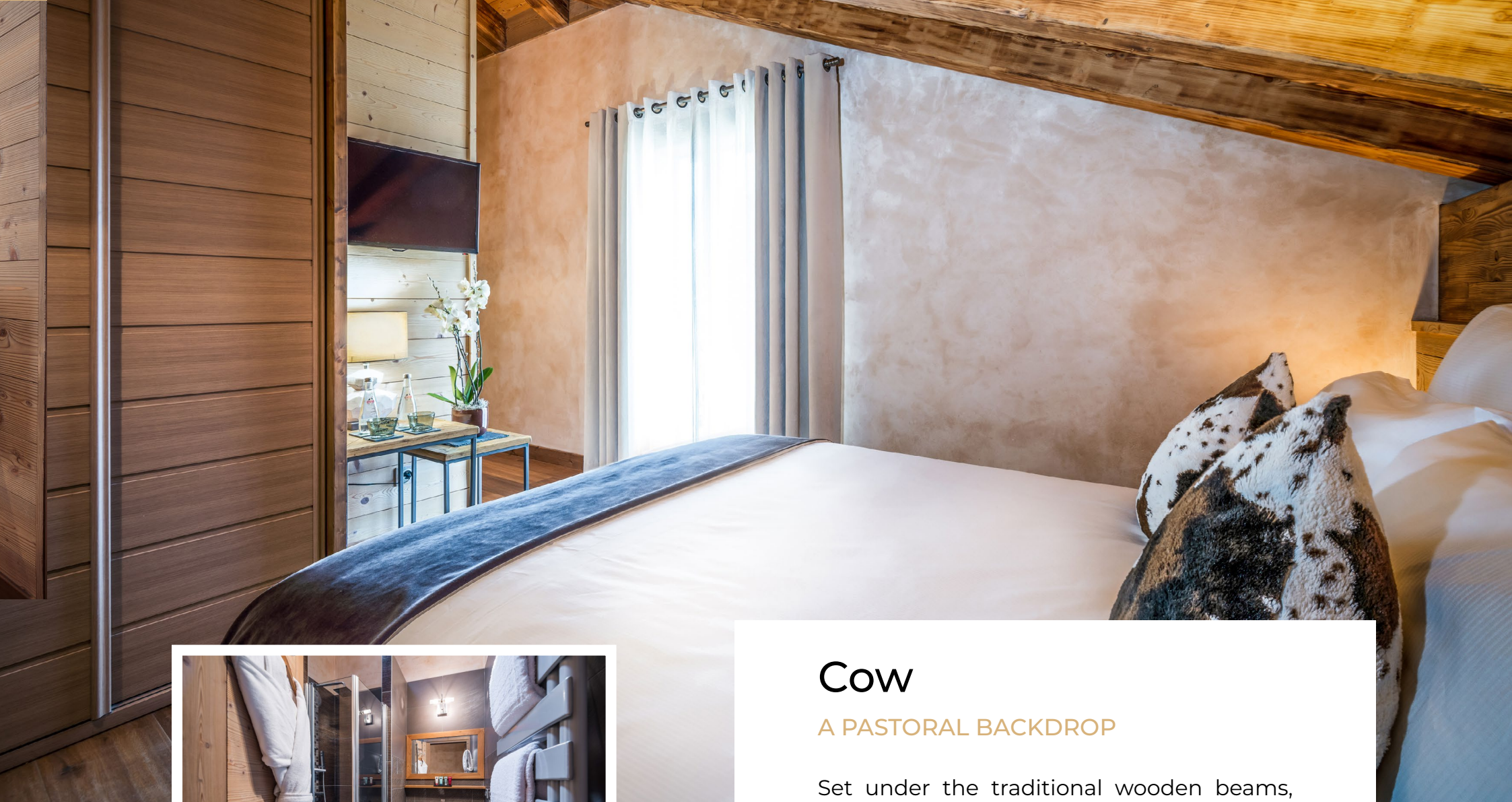

# Plume

ROCK-A-BYE

Ideal for children, this smaller bedroom exudes a soft warmth. It has a comfortable bed for sweet dreams, plenty of storage space and a very functional bathroom. The balcony facing the valley offers a timeless view.

15m<sup>2</sup> bedroom  
Queen bed 160cm x 200cm or two single beds



# Cow

A PASTORAL BACKDROP

Set under the traditional wooden beams, this authentic Savoyard style room is popular for its atmosphere and comfort. Overlooking the pastures, the balcony is a beautiful spot to daydream as you take in the panorama.

15m<sup>2</sup> bedroom  
Queen bed 160cm x 200cm



- LES ÉQUIPEMENTS
- Jacuzzi extérieur 6 places
  - Sauna extérieur 4 places
  - Draps de bain
  - Produits d'accueil



## Espace Bien-être

DETENDEZ-VOUS...

Sauna et jacuzzi extérieur avec vue sur les montagnes, pour votre détente, nous avons pensé à tout ! Cet espace “scandinave” est entièrement dédié à votre bien-être.

## Ski-room

SKIER DANS LES MEILLEURS CONDITIONS

Au réveil, votre matériel sera prêt et vos chaussures auront été chauffées pendant la nuit. Les pistes n'attendront plus que vous ! Seul lieu de rencontre avec le chalet – Le 1992 – il vous donnera l'occasion de partager vos expériences.

Boissons et barres céréales à disposition, tout est pensé pour que vous puissiez profiter au maximum des 600 km de pistes de ce majestueux domaine skiable des 3 Vallées. Ski aux pieds, il est l'heure de se laisser glisser ...



- LES ÉQUIPEMENTS
- Sèche-chaussures
  - Casiers à skis
  - Rangements pour le matériels
  - WC
- BUANDERIE COMMUNE AUX DEUX CHALETs
- Lave-linge
  - Sèche-linge
  - Fers et planches à repasser



# Imagine yourself at Chalets le 1992!

Floorplans of Chalet - Le 1992

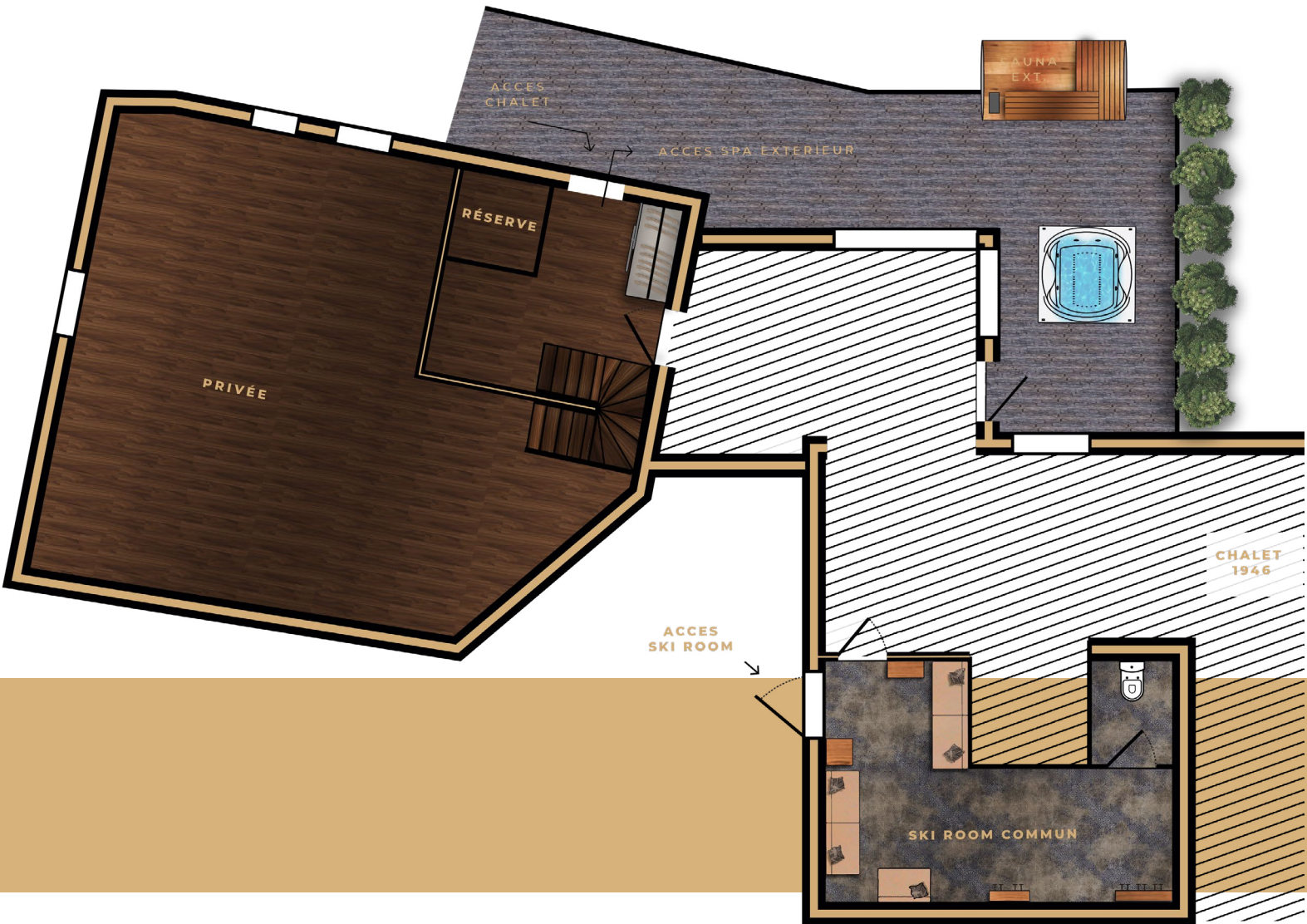



## A MAGICAL AND TAILOR-MADE HOLIDAY

From your arrival and throughout your stay at Chalets, you will benefit from an attentive, discreet and warm welcome. Going beyond the basics, our high quality service is included to offer you the best possible experience during your getaway with family or friends.

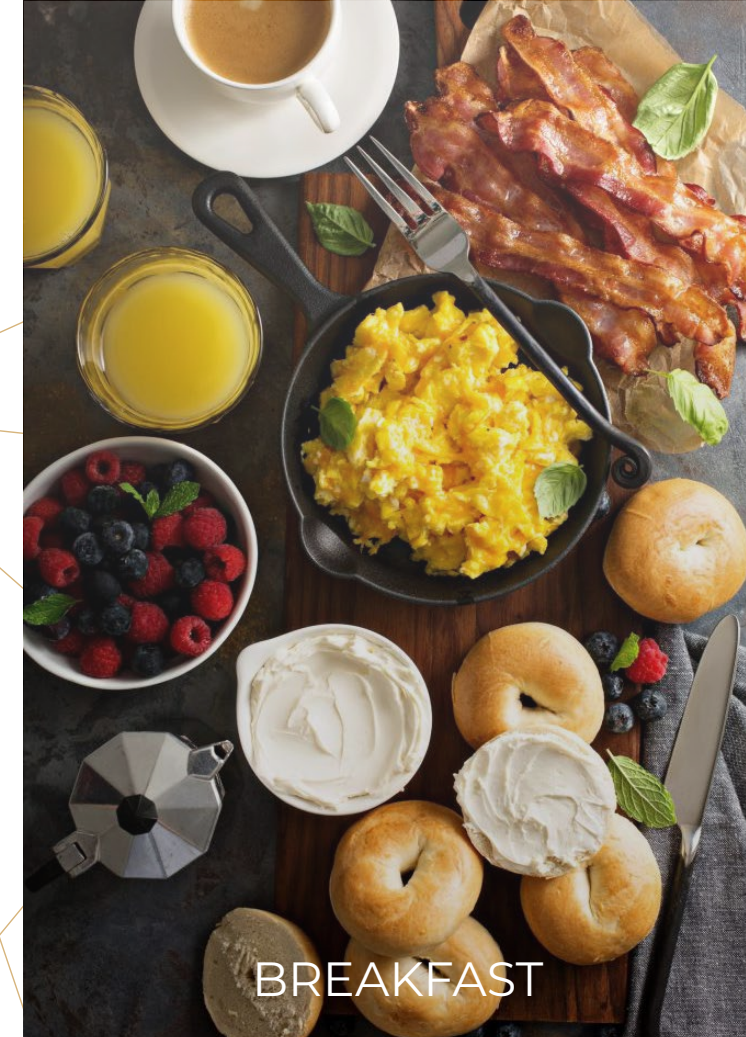

The perfect start to each day; a breakfast carefully prepared by our staff and served directly to the table – coffee, fruit juice, cakes, pancakes, scrambled eggs...

Always at your service, we are flexible to your needs and wants



For your convenience, our team will take care of the daily housekeeping of bedrooms and bathrooms, as well keeping your chalet neat and tidy.

Halfway through your stay we will discreetly provide a sheet change



When you arrive back after skiing, we will provide a delicious afternoon tea, including local specialties.

A different treat each day after a tiring day on the mountain.



# Le 1992



## SERVICES INCLUDED

Flowers and Champagne upon your arrival.

American breakfast prepared by our staff.

Tea time with homemade cakes or cakes prepared by our local artisans.

A top-of-the-range coffee machine from the Jura brand, offering a widechoice of drinks, self-service.

Daily maintenance of your chalet and change of sheets and linen once a week.

Daily preparation of the fireplace.

Unlimited access to newspapers via the Press-Reader app.

Many French and international channels. Also take advantage of Netflix, Canal + and •Sky Sport to follow all your sporting events.

Your ski equipment delivered directly to the ski-room of the chalet with our partner •Olympic Sport.

Baby welcome including: cot, night light, high chair, meal kit, adapted bath, bath thermometer, changing mat and toilet reducer.

Home kitchen including: washing up liquid, dishwasher tablets, tea towels, sponges, salt, pepper, sugar, olive oil and vinegar.

At your service and for any advice, our staff is available on site every day until 4:00 p.m.

To celebrate the end-of-year holidays, we are installing a beautifully decorated Christmas tree in your chalet.



## Pleasures of the table

### GASTRONOMIC TREATS

Enjoy an exceptional meal with all the comfort of being at home: our chalet chefs, rigorously selected by us will concoct inventive gourmet menus (including for vegetarians and children).

Alongside these gastronomic treats, you will have the pleasure of discovering a handpicked selection of reds, whites and champagnes, chosen by the head sommelier Laurent Naudot especially for our wine cellar.

Or why not take the opportunity to order exclusive dishes selected by us from our local partner restaurants, which will be delivered to your chalet. If you wish, let our team look after you and relax with your family and friends around a table set according to your meal.



CHALET CHEF



CATERING DELIVERY SERVICE



WINE AND CHAMPAGNE LIST





## The joy of Snow

### SLOPES

For winter sport lovers, make the most of the know-how from the family run OLYMPIC SPORT shop. We will deliver it free of charge to the ski-room, after you have had your equipment fitted in store.

Enjoy the slopes as quickly as possible, the new gondola that gives you access to the slopes and to Courchevel 1850 in just 8 minutes is located a few steps from your chalet.

Finally, to save you precious time, we take care of ordering your ski passes so you can get straight out on the slopes of the 3 Valleys area.



## Premium services

### BENEFIT

Having grown up in the village and having learnt their expertise in the resort's grandest palaces, our children will guide you around Courchevel and the immense Three Valleys area. No fewer than 19 Michelin stars have been awarded to the top 11 restaurants. Your taste buds will be delighted! The resort is also full of fantastic experiences and leisure activities for all ages; let us help you to make your holiday perfect.

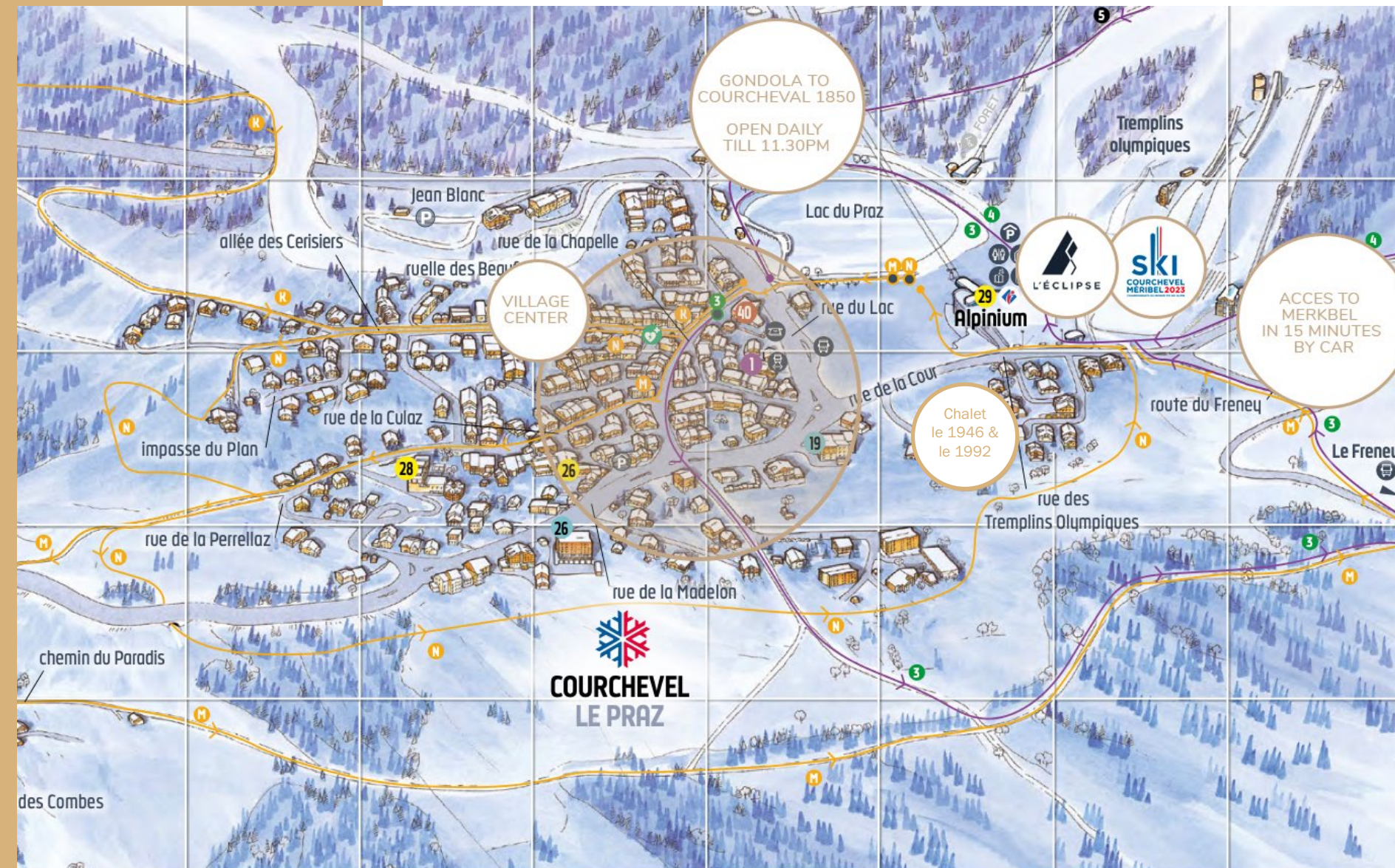

- 150 meters from the slopes and the gondola
- 150 meters from the village and these shops
- 8 minutes from Courchevel 1850 thanks to the PRAZ gondola and open every day until 11.30pm
- 15 minutes from Meribel by car
- Host of the 2023 Ski World Championships on the Eclipse slopes next to the Chalets





See you soon  
in Courchevel  
Le Praz